

Manitowoc Crane Group

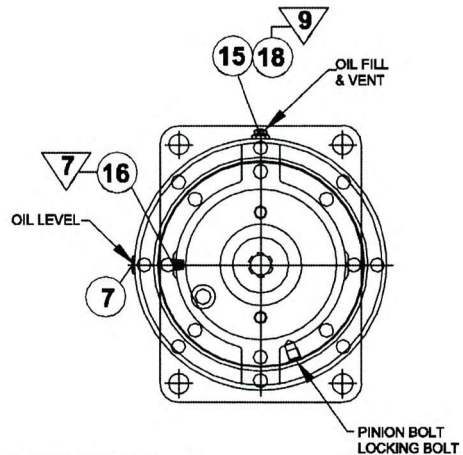

- 1 GREASE AND PACK BEARINGS (ITEM 4 & 6) WITH EP-2 BEFORE INSTALLATION.
- 2 TORQUE PINION BOLT TO 50 FT.-LBS., LOOSEN AND RE-TORQUE UNTIL PINION LOCKING BOLT ALIGNS WITH SLOT (25 FT.-LBS.)
- 3 APPLY LOCKTITE #709081 TO PINION BOLT.
- 4 BACKLASH TOTAL @ ASSEMBLY .004-.008.

- 5 BRAKE PERFORMANCE:
BRAKE FULL OFF @240 P.S.I. +/- 10%.
BRAKE SET TO SLIP BETWEEN 100-120 FT.-LBS. @ 155 P.S.I.
- 6 DO NOT ADD OIL.
- 7 PLUG ZERK WITH PIPE PLUG (ITEM 16), SHIP ZERK LOOSE IN BAG.
- 8 APPLY LOCKTITE TO PINION LOCKING BOLT AND TORQUE TO 20 FT.-LBS. (240 IN.-LBS.)
- 9 PLUG O-RING ADAPTER WITH PLASTIC CAPPLUG AND SHIP BREATHER LOOSE IN BAG.

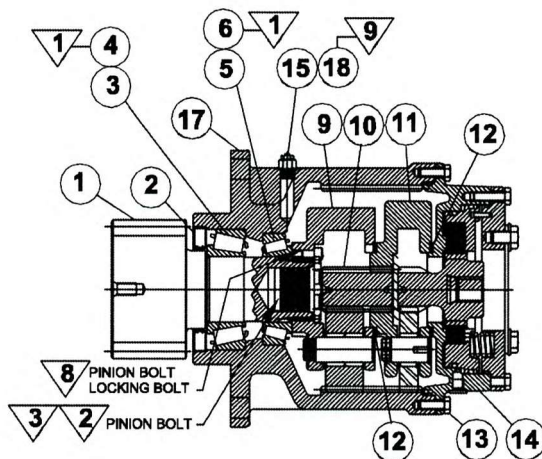